

Email [sales@airtarpsaustralia.com.au](mailto:sales@airtarpsaustralia.com.au)

## LONG BLOCK WATERPROOF MEASUREMENT SHEET

Customer: \_\_\_\_\_ Date: \_\_\_\_\_  
 Address: \_\_\_\_\_ Phone: \_\_\_\_\_  
 \_\_\_\_\_ Fax: \_\_\_\_\_

Contact: \_\_\_\_\_ Order/Rego No: \_\_\_\_\_ Email: \_\_\_\_\_

### WATERPROOF PLATE STYLE (Circle)

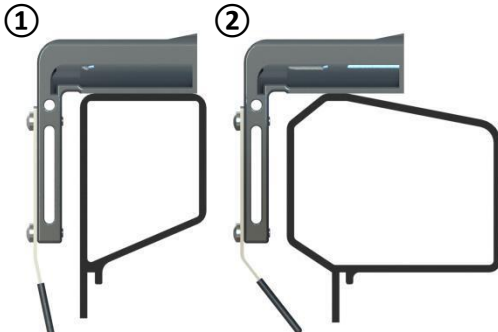

- ① Flush Body Plate
- ② Recessed Body Plate

### BODY TYPE

- Rigid Truck
- Dog Trailer
- Semi

Brand of Body: \_\_\_\_\_

### COLOUR SELECTION

(Circle one of the Following)

PVC: Black, Red, White,  
Grey, Blue, Maroon, Green,  
Yellow

### TAILGATE

- Two Way Gate
- Forward Hinged
- Rear Top Hinged
- Other

### NOTES

- Hoist box needs to be flush with the rail or lower
- Any height difference between the tailgate/hinges must be noted

### BOW SELECTION

Excavation Bows

- 150 mm
- 350 mm
- 450 mm



### OPERATING REQUIREMENTS

Manual Shaft

Drive Method

- Belt Driven
- Chain Driven

Electric System

- 12 Volt
- 24 Volt
- Manual Override

### REQUIRED DIMENSIONS

- A Outer width front \_\_\_\_\_
- B Outer width rear \_\_\_\_\_
- C \*Outside width \_\_\_\_\_
- D Overall Length \_\_\_\_\_
- E Front of Body to Hinge \_\_\_\_\_
- F Side Height \_\_\_\_\_
- G Width Across Back Posts \_\_\_\_\_
- H Inner Post Spacing \_\_\_\_\_

\*If body is bowed out, Measurement of the widest point is required

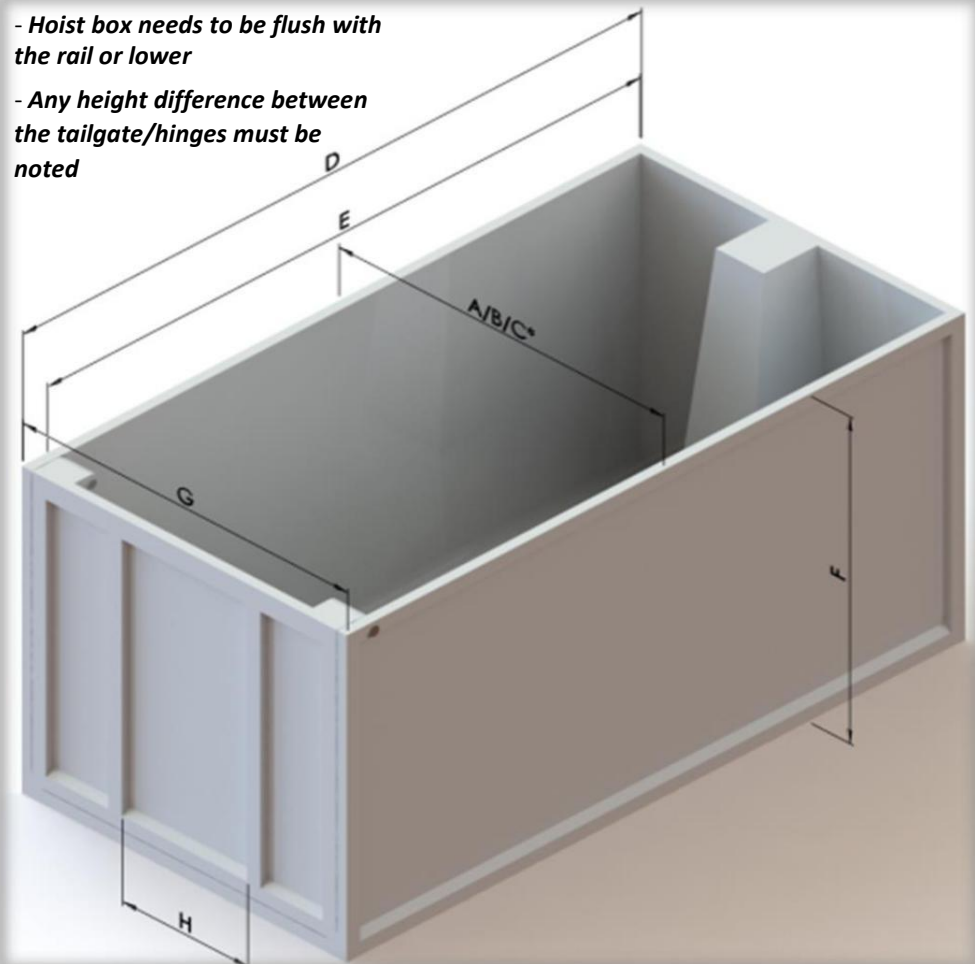

Notes